

**Caratteristiche:**

Diffusori a flusso elicoidale con getti regolabili.

**Costruzione:**

Acciaio verniciato bianco RAL 9010, deflettori in polipropilene nero RAL 9005

**Impiego:**

A soffitto, in mandata e ripresa (senza deflettori).

Altezza di installazione:  
2,5 - 4,1 m

**Fissaggio:**

Fissaggio con viti laterali o a mezzo vite centrale su ponte di montaggio.

**Accessori:**

- Plenum in acciaio zincato standard o isolato, con o senza rete equalizzatrice, serranda di taratura e ponte di montaggio.

**Characteristics:**

Swirl diffusers with adjustable throws

**Construction:**

RAL 9010 white painted steel, deflection blades are made of polypropylene RAL 9005 black.

**Utilization:**

For ceiling installation and for air intake (without deflectors) and delivery.

Installation height: 2,5 - 4,1 m.

**Fixing:**

Fixing by using lateral screws or central screw on mounting bridge.

**Accessories:**

- Galvanized steel plenum, standard or insulated, with or without equalizer sheet, calibration damper and mounting bridge.

**PREZZI / PRICES**

|       |     |         | BQE-1 Q-R | BQE-1 R-R | BQE-1 Q-Q |
|-------|-----|---------|-----------|-----------|-----------|
| mm    | Ø D | D       | €         | €         | €         |
| * 310 | 308 | 305x305 | -         | -         | -         |
| * 400 | 398 | 395x395 | -         | -         | -         |
| * 500 | 498 | 495x495 | -         | -         | -         |
| * 600 | 598 | 595x595 | -         | -         | -         |
| 625   | 623 | 620x620 | -         | -         | -         |
| 800   | 798 | 795x795 | -         | -         | -         |

**PREZZI / PRICES PLENUM BQE-1 Q-R / BQE-1 Q-Q**

|        |      | Cannotto Spigot | PQZ-1 | PQZI-1 | PQZ-2 | PQZI-2 | Serranda Damper | Equalizzatore Equalizer | Ponte di fissaggio Fixing bridge |
|--------|------|-----------------|-------|--------|-------|--------|-----------------|-------------------------|----------------------------------|
| AxB mm | Ø mm | €               | €     | €      | €     | €      | €               | €                       | €                                |
| 310    | 123  | -               | -     | -      | -     | -      | -               | -                       | -                                |
| 400    | 148  | -               | -     | -      | -     | -      | -               | -                       | -                                |
| 500    | 198  | -               | -     | -      | -     | -      | -               | -                       | -                                |
| 600    | 248  | -               | -     | -      | -     | -      | -               | -                       | -                                |
| 625    | 298  | -               | -     | -      | -     | -      | -               | -                       | -                                |
| 800    | 348  | -               | -     | -      | -     | -      | -               | -                       | -                                |

**PREZZI / PRICES PLENUM BQE-1 R-R**

|     | PLENUM ZINCATO mm / GALVANIZED PLENUM mm |     |     | PDC | PDCI | Serranda Damper | Equalizzatore Equalizer | Ponte di fissaggio |
|-----|--|-----|-----|-----|------|-----------------|-------------------------|--------------------|
|     | AxA                                      | ØD  | ØE  |     |      |                 |                         |                    |
| mm  | mm                                       | mm  | mm  | €   | €    | €               | €                       | €                  |
| 308 | 400                                      | 123 | 300 | -   | -    | -               | -                       | -                  |
| 398 | 500                                      | 148 | 390 | -   | -    | -               | -                       | -                  |
| 498 | 600                                      | 198 | 490 | -   | -    | -               | -                       | -                  |
| 598 | 700                                      | 248 | 590 | -   | -    | -               | -                       | -                  |
| 623 | 700                                      | 298 | 615 | -   | -    | -               | -                       | -                  |
| 798 | 900                                      | 348 | 790 | -   | -    | -               | -                       | -                  |

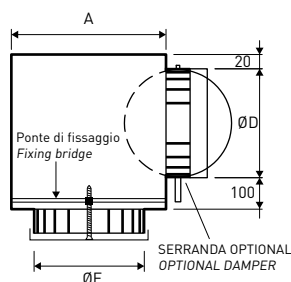
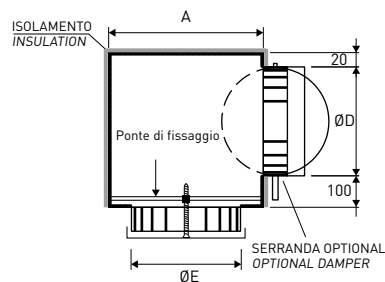
**PLENUM PDC****PLENUM PDCI**

DISEGNI / DRAWINGS

**BQE-1 Q-R**

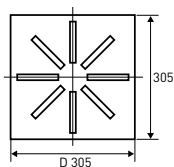

**BQE-1 R-R**

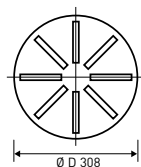

**BQE-1 Q-Q**

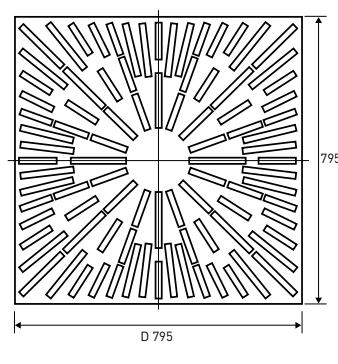
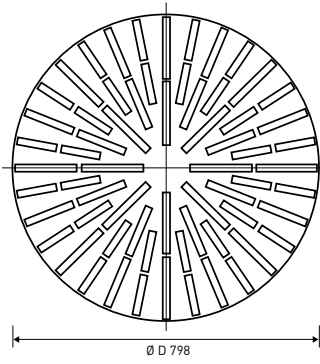
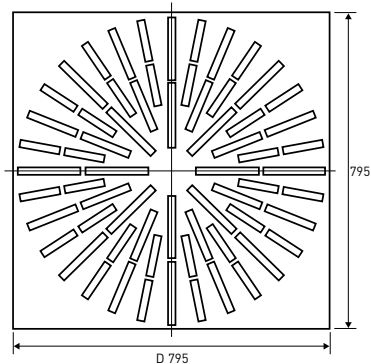
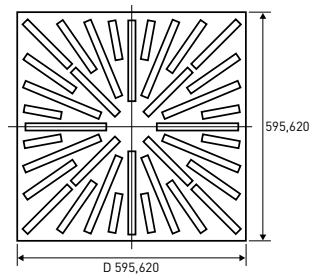
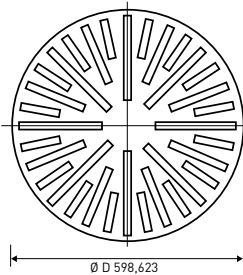
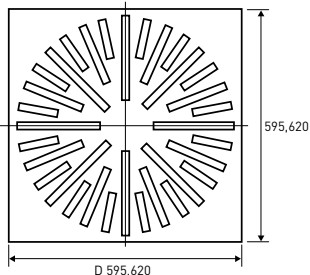
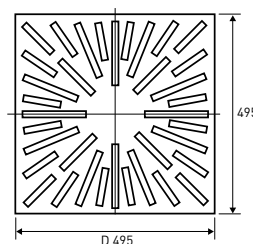
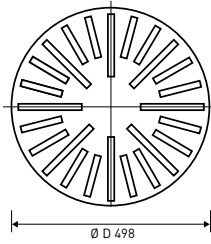
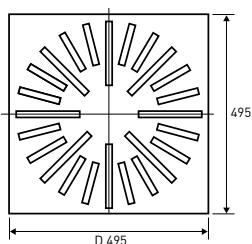
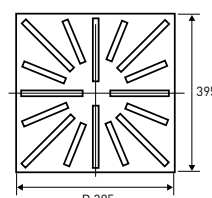
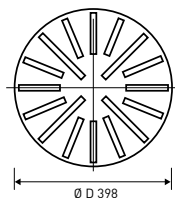
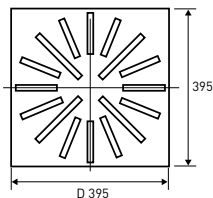
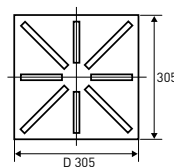

**PQZ-1**

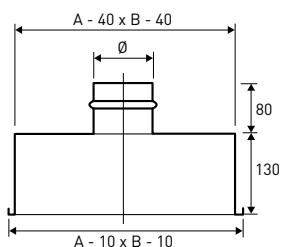

**PQZ-2**

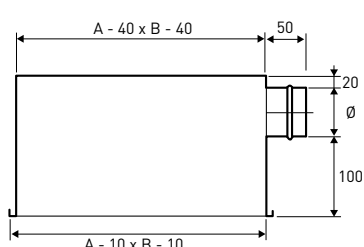

**PQZI-1**

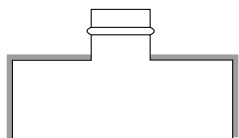

**PQZI-2**

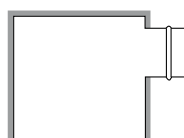

**Particolare montaggio  
Assembly detail**

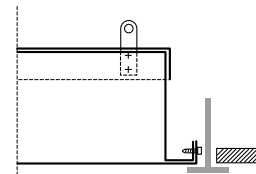

Plenum isolato esternamente spessore 6 mm  
Plenum externally insulated thickness 6 mm

DIAGRAMMA SCELTA RAPIDA / QUICK SELECTION DIAGRAM



TABELLA DI SELEZIONE / SELECTION TABLE

| Modello<br>Model      | A <sub>v</sub> [m <sup>2</sup> ] | Q [m <sup>3</sup> /h] |      | L <sub>wa</sub> [dB(A)] |     | X <sub>(0,20)</sub> [m] |      | Dp <sub>t</sub> [Pa] |     |
|-----------------------|----------------------------------|-----------------------|------|-------------------------|-----|-------------------------|------|----------------------|-----|
|                       |                                  | min                   | max  | min                     | max | min                     | max  | min                  | max |
| <b>BQE1 Q/R-R 310</b> | 0,0128                           | 130                   | 290  | 24                      | 41  | 1,3                     | 2,9  | 10                   | 50  |
| <b>BQE1 Q/R-R 400</b> | 0,0223                           | 230                   | 490  | 24                      | 41  | 1,8                     | 3,8  | 10                   | 50  |
| <b>BQE1 Q/R-R 500</b> | 0,0361                           | 360                   | 800  | 24                      | 41  | 2,2                     | 4,8  | 10                   | 50  |
| <b>BQE1 Q/R-R 600</b> | 0,0536                           | 540                   | 1180 | 24                      | 41  | 2,7                     | 5,8  | 10                   | 50  |
| <b>BQE1 Q/R-R 625</b> | 0,0536                           | 540                   | 1180 | 24                      | 41  | 2,7                     | 5,8  | 10                   | 50  |
| <b>BQE1 Q/R-R 825</b> | 0,1081                           | 1080                  | 2360 | 24                      | 40  | 3,8                     | 8,2  | 10                   | 50  |
| <b>BQE1 Q-Q 310</b>   | 0,0185                           | 270                   | 530  | 30                      | 50  | 2,3                     | 4,5  | 10                   | 50  |
| <b>BQE1 Q-Q 400</b>   | 0,0315                           | 460                   | 890  | 30                      | 49  | 3,0                     | 5,7  | 10                   | 50  |
| <b>BQE1 Q-Q 500</b>   | 0,0500                           | 720                   | 1390 | 30                      | 49  | 3,7                     | 7,1  | 10                   | 50  |
| <b>BQE1 Q-Q 600</b>   | 0,0729                           | 1040                  | 2010 | 30                      | 48  | 4,4                     | 8,5  | 10                   | 50  |
| <b>BQE1 Q-Q 625</b>   | 0,0729                           | 1040                  | 2010 | 30                      | 48  | 4,4                     | 8,5  | 10                   | 50  |
| <b>BQE1 Q-Q 800</b>   | 0,1425                           | 1990                  | 3850 | 29                      | 48  | 6,0                     | 11,7 | 10                   | 50  |

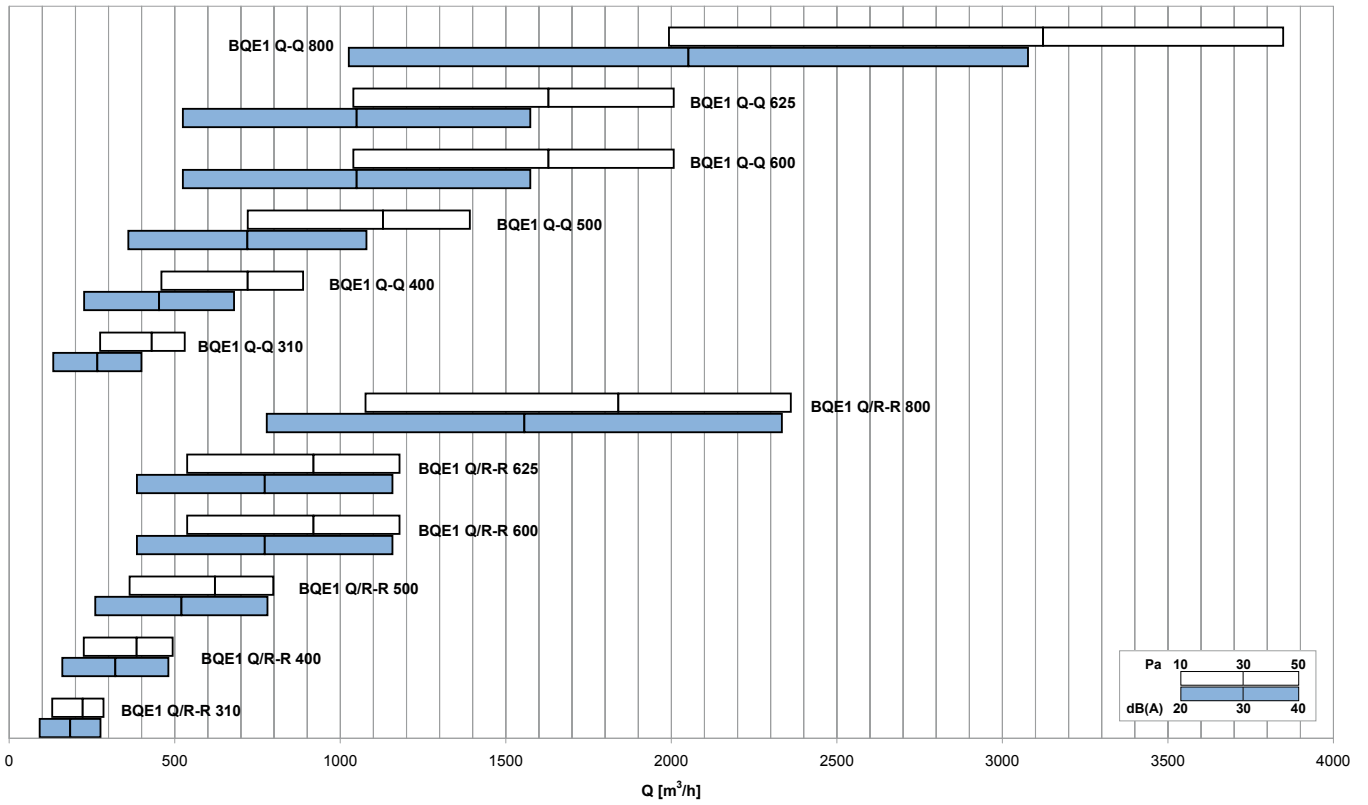